

↕ **IRION** **LANCER** **JUMBO**

bulmor
strong sideloader solutions



Technical
Information

**Sideloaders
DQ 130-150**





Sideloaders lifting 13-15 tons

Designed for heavy loading due to its solid steering axle and centrepiece construction.

The big wheels, the high-performance drive and the exceptionally solid lift mast ensure power reserves when it comes to extraordinary applications. This machine category easily, comfortably and safely handles loads up to 15 tons. They are characterised by their high availability and excellent durability.

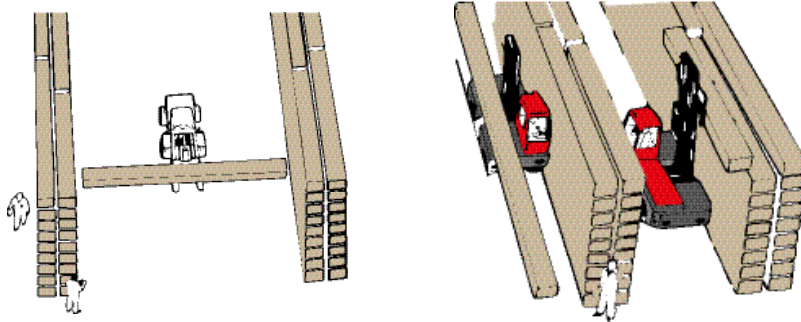

FACTS

Lifting capacity	13 to 15 tons
Engine	diesel
Drive	hydrostatic
platform height	1.530 mm*
Platform widths	from 1.100 mm
Lifting heights	up to 8.000 mm

* with wooden platform



Intended front wheel for narrow turning radius with maximum steering angle

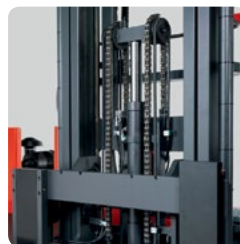

Solid lifting mast

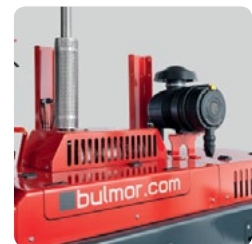

Big service flaps for easy maintainability

Sideloader DQ 130-150

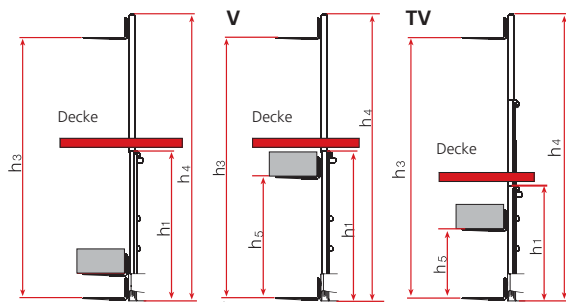

Mast Matrix DQ-Heavy-Line-Sideloader 13 to & 15 to.

Platform width max. 2000 mm, wider than 2000 mm on demand

mast fully lowered, mast fully extended, free lift

DQ 130-150 *

	Lift height (h3)	Height lowered (h1)	Height extended (h4) **	Free lift (h5) **
Duplex-Mast without freelif	4000	3550	5590	0
	4500	3800	6090	0
	5000	4050	6590	0
	5500	4300	7090	0
	6000	4550	7590	0
Duplex- Freelif-Mast	4000	3650	5625	2025
	4500	3900	6125	2275
	5000	4150	6625	2525
	5500	4400	7125	2775
	6000	4650	7625	3025
Triplex-Mast	4500	3070	6125	1445
	5000	3230	6625	1605
	5500	3400	7125	1775
	6000	3570	7625	1945
	6500	3730	8125	2105
	7000	3900	8625	2275
	8000	4230	9625	2605

* ... and identical types in construction

** ... with standard carriage

RESIDUAL CAPACITY DQ 130 // DQ 150

Platform width (mm)	Lift height (mm)								
	4	4,5	5	5,5	6	6,5	7	7,5	8
1600	13000/15000	12640/14570	12110/14020	11670/13400	11160/12870	10650/12280	10240/11770	9840/11200	9360/10710
1800	13000/15000	12730/14690	12190/14070	11750/13540	11230/12950	10730/12360	10320/11860	9910/11310	9430/10830
2000	13000/15000	12810/14600	12300/14260	11800/13730	11310/13200	10830/12600	10360/12090	9970/11590	9520/11100

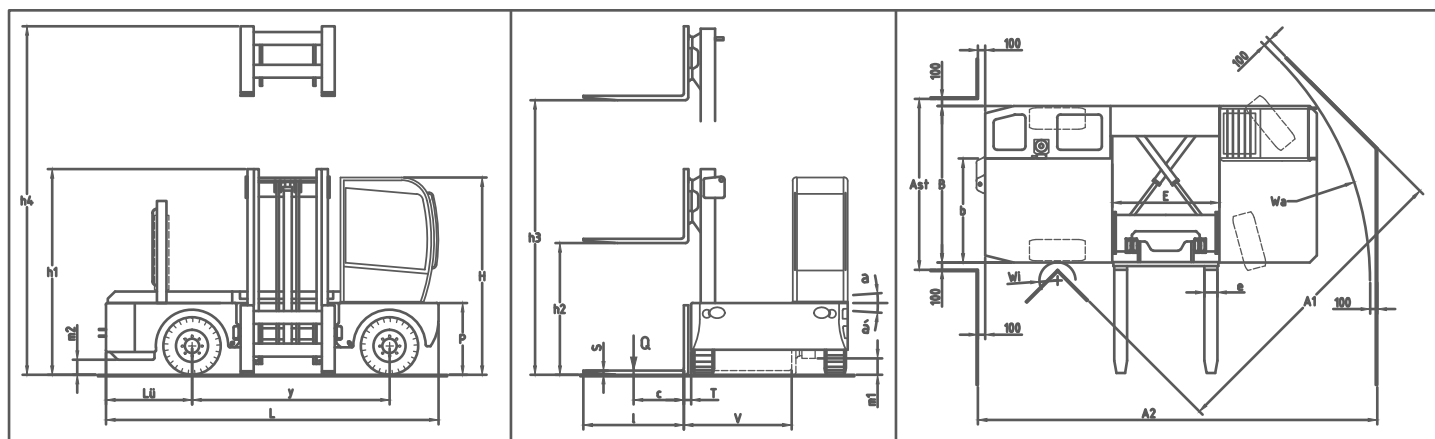

Manufacturer specifications and quality characteristics

		Manufacturer		Bulmor industries GmbH				
Characteristics	1	Manufacturer						
	2	Type	manufacturer's type designation		DQ 130/16 (18)	DQ 150/16 (18)		
	3	Lifting capacity	Q	without stabilisers	t	13	15	
	4	Load centre	c	distance	mm	800 (900)	800 (900)	
	5	Drive	diesel, LPG, electro		diesel			
	6	Operator position			seated			
	7	Type of steering	V-solid rubber, L-pneumatic, front/rear		L / L	L / L		
	8	Wheels	number front/rear (X= drive wheels)		2/2X	2/2X		
Dimensions	9	Lift	h3	lift height	mm	4000	4000	
	10		h2	free lift	mm	no free lift	no free lift	
	11	Fork carriage	fork spread		mm	500 - 1640	500 - 1640	
	12	Fork dimensions	s/e/l		mm	80 (90) /250/1600 (1800)	80 (90) /250/1600 (1800)	
	13	Tilt of mast	forward/backward		degree	±4,5° (±3,8°)	±4,5° (±3,8°)	
	14	Overall dimensions	L	Overall length	mm	6650	6650	
	15		B	Overall width	mm	2600 (2800)	2600 (2800)	
	16		h1	height, mast lowered	mm	3550	3550	
	17		h4	height, mast extended	mm	5590	5590	
	18		H	overall height cabin	mm	3520	3520	
	19		Platform	b	platform width	mm	1600 (1800)	1600 (1800)
	20	E		well width	mm	1800	1800	
	21	P		platform height	mm	1530*	1530*	
	22	Mast reach	T	fork face standout	mm	100	100	
	23		V	traverse stroke	mm	1700 (1900)	1700 (1900)	
	24	Overhang length	Lü		mm	1730	1730	
	25	Turning radius	outer/inner		mm	6090 (6210) /970	6090 (6210) /970	
	26	Aisle width	Ast	for driving straight line	mm	2800 (3000)	2800 (3000)	
	27		A1	for 90° turning	mm	5620 (5740)	5620 (5740)	
	28		A2	for 90° turning within aisle	mm	8020 (8140)	8020 (8140)	
	Performance	29	Speed	travel speed with/without load		km/h	24/25	24/25
		30		lift speed with 80% max. load/without load		m/s	0,28/0,28	0,28/0,28
		31		lowering speed with/without load		m/s	0,57/0,23	0,57/0,23
		32		traverse speed		m/s	0,32	0,32
33		Drawbar pull			daN	8300	8300	
34	Gradeability	with/without load		%	21/36	19/34		
Weight	35	Machine weight	without load		kg	21400 (21900)	22900 (23400)	
	36	laden weight	front axle		kg	16410 (16640)	18100 (18330)	
	37	laden weight	rear axle		kg	17990 (18260)	19800 (20070)	
Chassis	38	Tyres	number front/rear		pc	2/2	2/2	
	39		dimension front			14.00-24	14.00-24	
	40		dimension rear			14.00-24	14.00-24	
	41	Wheelbase	y		mm	3920	3920	
	42	Track	front/rear		mm	2140/2140 (2340/2340)	2140/2140 (2340/2340)	
	43	Ground clearance	with load m1 below mast		mm	300	300	
	44		with load m2 mid wheelbase		mm	300	300	
	45	Service brake	front/rear		hydraulic / hydrostatic			
Transmission	46	Parking brake	rear		electrohydraulic			
	47	Battery			start battery			
	48		voltage/capacity	V/Ah	24/135			
	49	Engine	manufacturer/model		Perkins 1206E-E66TA Common Rail			
	50		max. rated power to DIN 70020	kW(PS)	116,5 (158)			
	51		rated speed	1/min	2200			
	52		cylinders/capacity (ccm)	6/6600				
	53	Transmission			hydrostatic			
	54	Clutch			seamless clutch			
	55	Stability			ISO 22915			

Technical changes reserved. * with wooden platform

01.05.2015 Rev.0



Timber, steel, aluminium, tubes etc. - our machines master all kinds of operations in most diverse industries.



References and applications



**Glued laminated timber
profiles
pipes
steel**

Our machines handle any long
and heavy material.
We offer comfortable and
safe handling of goods.

In the field of sideloaders and multidirectional sideloaders, Bulmor is the specialist in creating perfect solutions for each individual customer. Our products' profound quality coupled with robustness and safety makes us the ideal and reliable business partner.

Our bespoke sideloaders and multidirectional sideloaders are designed and produced in Bulmor's Upper-Austrian headquarters and excel through innovation, customer benefit, durability and great availability. As a matter of course, our machines are operated in the whole world, in different industries, from plastics and timber to concrete and steel applications.



- Sideloaders
- Multidirectional Sideloaders
- Ground Support Equipment

Head office Austria
Bulmor industries GmbH
Kickenau 1
A-4320 Perg

t +43 7262 58397-0
f +43 7262 52297-11
e info@bulmor.com

Branch office Germany
Bulmor Deutschland GmbH
Hurststraße 2
D-77815 Bühl

Branch office UK
Bulmor Lancer Ltd.
Chartmoor Road
Leighton Buzzard

